

Image may differ from product. See technical specification for details.

SMSW 42 -ASTR

Spherical washer

Spherical washers are designed to create an exact, parallel plane between the bolt head and the face of the nut. These washers automatically adjust and compensate for the angular deviation between the planes and prevent the bolt from bending.

- Automatically compensates for angular errors
- Evenly distributed bolt tension
- Reduces bolt fatigue from bending bolts
- Improved bolt stretch possible due to increased clamping length
- Surface treated for protection in humid and harsh environments
- Available in standard and low-profile (LP) versions

개요

치수

| | |
|-------|-------|
| 보어 직경 | 46 mm |
| 외경 | 82 mm |
| 높이 | 60 mm |

속성

| | |
|-----------|--------------------------------------|
| 재료 | Alloy Steel. surface treated |
| Treatment | 연질화처리됨 |
| 응용 분야 | Machinery installed on SKF Vibracons |

물류

| | |
|-----------|-------------|
| 제품 순 중량 | 1.49 kg |
| eClass 코드 | 23-05-20-01 |
| UNSPSC 코드 | 20122410 |

기술 사양

| | |
|-----------|------------------------------|
| 설계 | 표준 |
| 재료 | Alloy Steel, surface treated |
| Treatment | 연질화처리됨 |
| 컬러 | Metallic black |

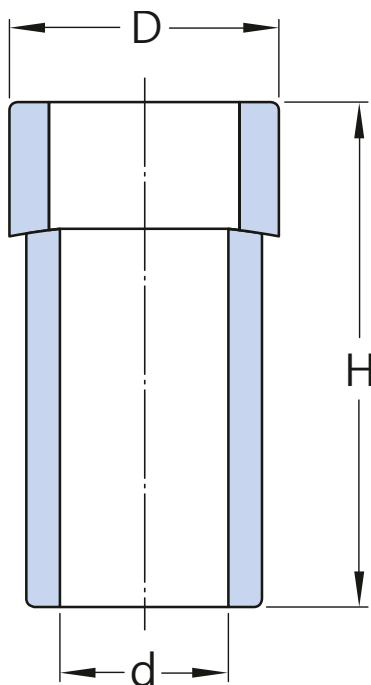

치수

| | | |
|---|-------|-------|
| d | 46 mm | 보어 직경 |
| D | 82 mm | 외경 |
| H | 60 mm | 공칭 높이 |

호환 제품

권장 제품

| | |
|---|--------------------------------|
| Vibracon adjustable chocks, carbon steel | SM 42 E-CS |
| Vibracon adjustable chocks, surface treated | SM 42 E-CSTR |
| Vibracon adjustable chocks, stainless steel | SM 42 E-SS |
| Vibracon adjustable chocks, low profile | SM 42 ELP-ASTR |
| Vibracon adjustable chocks, carbon steel | SM 36 E-CS |
| Vibracon adjustable chocks, surface treated | SM 36 E-CSTR |

Vibracon adjustable chocks, stainless steel

[SM 36 E-SS](#)

Vibracon adjustable chocks, low profile

[SM 36 ELP-ASTR](#)

이용약관