

Image may differ from product. See technical specification for details.

SMSW 20 -ASTR

Spherical washer

Spherical washers are designed to create an exact, parallel plane between the bolt head and the face of the nut. These washers automatically adjust and compensate for the angular deviation between the planes and prevent the bolt from bending.

- Automatically compensates for angular errors
- Evenly distributed bolt tension
- Reduces bolt fatigue from bending bolts
- Improved bolt stretch possible due to increased clamping length
- Surface treated for protection in humid and harsh environments
- Available in standard and low-profile (LP) versions

개요

치수

보어 직경	23 mm
외경	42 mm
높이	60 mm

속성

재료	Alloy Steel. surface treated
Treatment	연질화처리됨
응용 분야	Machinery installed on SKF Vibracons

물류

제품 순 중량	0.33 kg
eClass 코드	23-05-20-01
UNSPSC 코드	20122410

기술 사양

설계	표준
재료	Alloy Steel, surface treated
Treatment	연질화처리됨
컬러	Metallic black

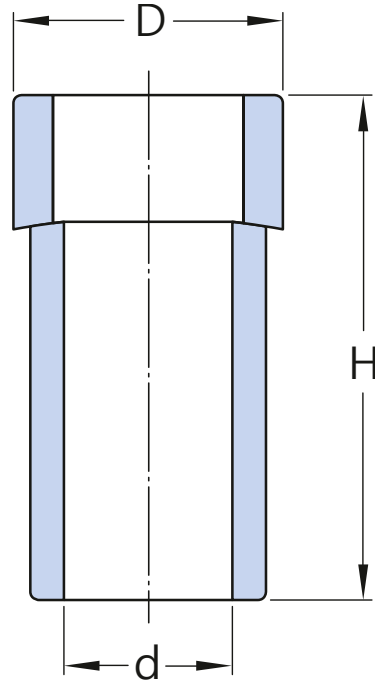

치수

d	23 mm	보어 직경
D	42 mm	외경
H	60 mm	공칭 높이

호환 제품

권장 제품

Vibracon adjustable chocks, carbon steel	SM 20 E-CS
Vibracon adjustable chocks, surface treated	SM 20 E-CSTR
Vibracon adjustable chocks, stainless steel	SM 20 E-SS
Vibracon adjustable chocks, low profile	SM 20 ELP-ASTR
Vibracon adjustable chocks, carbon steel	SM 16 E-CS
Vibracon adjustable chocks, surface treated	SM 16 E-CSTR

Vibracon adjustable chocks, stainless steel

[SM 16 E-SS](#)

Vibracon adjustable chocks, low profile

[SM 16 ELP-ASTR](#)

이용약관